

LOUISA COUNTY, IOWA
PERMIT TO ENCROACH UPON RIGHT-OF-WAY

Applicant _____ Telephone Number _____

Address _____
(Street/Post Office Box) (City) (State) (Zip Code)

In accordance with the policy of the Louisa County Board of Supervisors, applications for plowing, tilling or planting of grasses within County right-of-way; fencing across an open waterway or in the right-of-way; excavation in the roadway or road ditches including the deepening of a ditch, excavation, fill or physical change in the right-of-way; or any other use of the right-of-way other than specified above must be approved by the Engineer's Office.

Please use the following diagram of a typical section to locate the proposed encroachment.

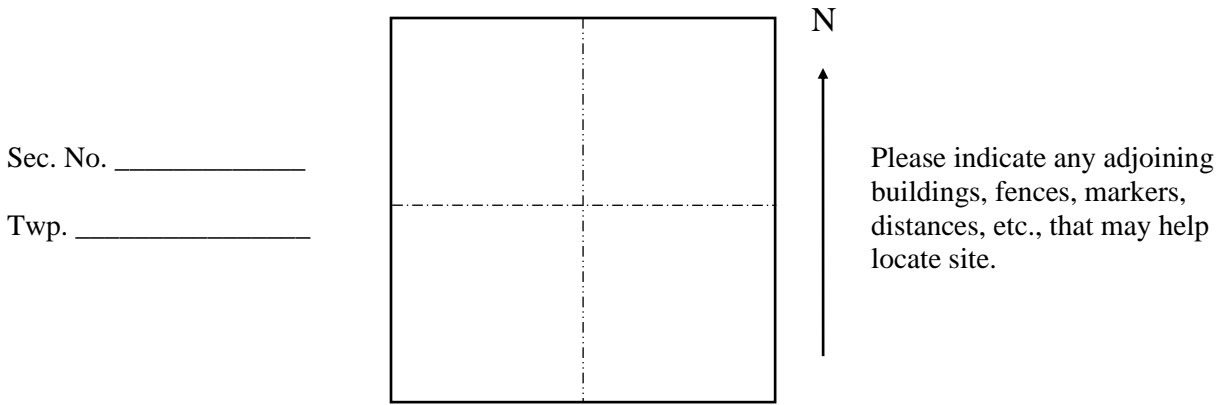

Describe intended use of right-of-way: _____

Comments: _____

Restrictions: _____

Date: _____

Signature of Applicant

----- Office Portion -----

Reviewed by _____ Date _____

Approved by _____ Date _____